

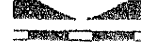





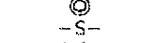
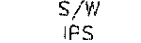
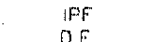
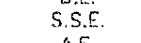
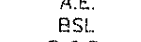
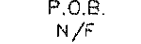
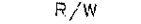

2. ALL MATTERS OF TITLE ARE EXCEPTED.  
3. THIS PLAT IS SUBJECT TO ALL LEGAL EASEMENTS AND RIGHTS-OF-WAY, PUBLIC OR PRIVATE.

**\* P.O.B.**

BEGINNING AT INTERSECTION WITH THE CENTERLINE OF SARDIS BEND DR. AND THE CENTERLINE OF SARDIS CHASE COURT; RUNNING THENCE ALONG SAID CENTERLINE OF SARDIS CHASE COURT 885.88' TO A POINT.

-  JUNCTION BOX/STORM SEWER MANHOLE HEADWALL
-  CATCH BASINS
-  STORM SEWER LINE
-  SUBDIVISION LOT NUMBER
-  PROPERTY CORNER
-  FIELD LOCATED PIN (AS NOTED)
-  SANITARY SEWER LINE
-  SIDEWALK
-  IRON PIN SET
-  IRON PIN FOUND
-  DRAINAGE EASEMENT
-  SANITARY SEWER EASEMENT
-  ACCESS EASEMENT
-  BUILDING SETBACK LINE
-  P.O.B.
-  NOW OR FORMERLY
-  RIGHT-OF-WAY

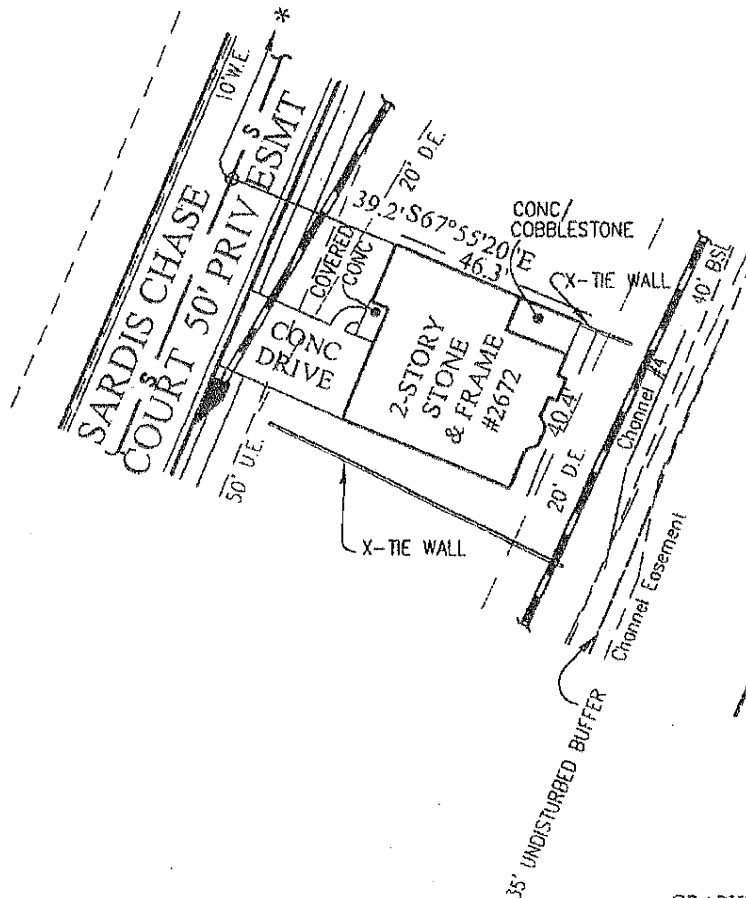
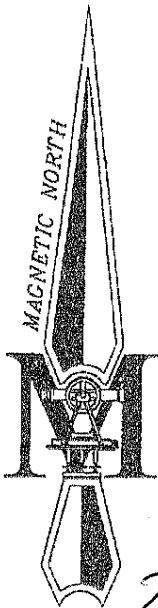

I HAVE REVIEWED THIS SURVEY.  
*LCN*

GRAPHIC SCALE - IN FEET

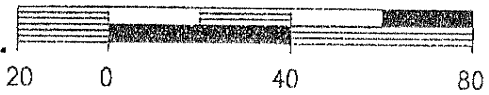

2672 Sardis Chase Ct.  
Buford

LOAN SURVEY FOR  
VIDALE HAMILTON



**CHRISTOPHER E. MOORE & ASSOCIATES, INC.**  
PROFESSIONAL LAND SURVEYING  
320 NORTH CLAYTON STREET - LAWRENCEVILLE, GA. 30045  
Phone: (770) 963-7418 Fax: (770) 963-7995

LOT# 70  
BLOCK A  
CARLTON  
PLAT NOT RECORDED  
LAND LOT 1C  
1ST DISTRICT  
GWINNETT, GA.  
APRIL 4, 2006 ~ SCALE: 1" = 40'  
JOB# 06263

